

ENGLISH

Congratulations on your purchase of the Micralite Toro. The Superlite has been designed for safety, comfort and ease of use. We hope you and your child enjoy the freedom provided by the Micralite Toro.

If you have any questions or comments, we will be pleased to help: info@micralite.com

The Toro is suitable from birth with the use of the Micralite Air-flo carrycot or the Maxi Cosi Cabriofix or Pebble car seat*. We recommend that the Toro seat is used as soon as your child is able to sit up unassisted, usually around 6 months.

General Information

IMPORTANT: READ THESE INSTRUCTIONS CAREFULLY BEFORE USE AND KEEP FOR FUTURE REFERENCE. Your child's safety may be affected if you do not follow these instructions.

Maximum weight in seat not to exceed 15kgs. Maximum weight in the underseat bag not to exceed 2kgs evenly distributed. No bag to be hung from the handlebars, as to do so will adversely effect the stability and safety of the stroller. The Superlite is designed to carry one child at a time.

Always remove child from the stroller when ascending or descending stairs or escalators.

WARNING: A child's safety is your responsibility.

WARNING: It may be dangerous to leave your child unattended.

Children should be harnessed at all times. The child should be kept clear of all moving parts while making adjustments. Overloading, incorrect folding and the use of non-approved accessories may damage or break this vehicle.

* Maxi-Cosi is the trademarks of their respective owners. They are not associated with Micralite Limited and no approval or endorsement by them is to be implied.

WARNING: This seat is not suitable for a child under 6 months.

WARNING: Check that the seat unit attachment devices are correctly engaged before use.

WARNING: Ensure that all locking devices are engaged before use.

WARNING: Any load attached to the handle affects the stability of the pushchair.

WARNING: Always use the crotch strap in combination with the waist belt.

WARNING: This product is not suitable for skating or running.

General care and maintenance - regularly check the vehicle to ensure everything functions properly.

Tyre pressures - Keep tyres inflated to 1.5 bar (22 psi) using hand pump. Adaptor in pump handle) Punctures can be repaired at any cycle shop.

Always lift the front wheels over kerbs and steps, as repeated impact may cause damage.

Clean frame with warm water, pay particular attention to washing away sand or mud from sliding parts of the frame.

Never use strong detergent or solvents.

Always allow seat and raincover to dry before folding.

Clean the seat, hood and raincover with a damp cloth - do not use strong detergent or solvents. It is unsafe to use spare parts and accessories other than those supplied by Micralite.

Manufactured by Micralite Limited TN3 9BD. This product is designed and manufactured to comply with EN1888:2003. Micralite Limited has the right to make changes to any of their products as part of continuing development and improvement.

1 Preparing the stroller for use - please refer to the illustrations.

Once out of the box, remove the two plastic protectors from the rear wheel axle and clear plastic tubes from the brake and discard.

Attach the rear wheels by sliding onto the axle as shown **A**. Press the wire clip **B** towards the centre of the wheel to allow the wheel to fully engage. Check the wheel is firmly connected.

2 To open the stroller

With the stroller standing upright and brake applied, squeeze recline lock plungers together **C** on both sides and push down, which in turn will open out the front legs of the stroller. Continue to push all the way down until the lock engages and 2 clicks are heard. Please ensure the locks have fully engaged. By squeezing the recline lock plungers again and lifting upwards, the seat can be adjusted to the required recline position. By releasing the plunger when sliding up or down, the lock will automatically engage into the next recline position. The stroller is now ready for your child.

3 To operate the brake

To engage the brake - using foot press down pedal **D** until a click is heard. Ensure both wheels are properly locked by rocking the stroller back and forth with the pedal engaged. To release, lift pedal **D** with the foot.

4 To fold the stroller

If open, fold back the hood and remove the raincover. If locked, release the front wheel swivel locks.

Press down on button **E** with thumb while lifting handle **F**. Then depress lever marked "Press". These actions will disengage the safety locks.

In a swift action, pull up lever **F** to fold the stroller. (Tip - pulling the stroller in a backward direction will orientate the front swivelling wheels in a forward facing direction. This will help the front wheels to nest within the rear wheels to achieve a compact fold).

The recline lock plungers **C** with automatically engage when fully folded. Note - a small push on the front of the seat will help to lock the frame.

5 To operate and adjust the harness

To release the harness, depress the button in the middle of buckle **G**.

To fasten the harness, slide both fasteners **H** into the buckle until a click is heard.

To adjust the length of the waist straps, press button **I** and slide adjuster **J** to the required length. To adjust the length of the shoulder straps, slide adjuster **K** to the required length.

The shoulder and waist straps should fit your child snugly.

Additional "D" rings **L** are included for the attachment of a separate harness which must conform to BS6684.

6 To adjust the legrest

The legrest can be adjusted into a horizontal position to support your child's legs by depressing the white buttons **M** on both sides of the frame.

7 To operate the front wheel swivel locks

To engage the swivel locks, push the stroller in a forward direction to align the wheels, then simply push down wheel locks until a click is heard.

8 Adjusting the handlebars

Simply lift the two levers on the top of the handlebar clamps, rotate the handlebars to the required position, then push the levers back down to lock.

9 Fitting the rain cover

Remove rain cover from roll bag, with elasticated section at the bottom, place the rain cover over the opened hood, then stretch the bottom section around the base of the foot rest. The elastic can then be tightened using the plastic toggle.

10 Hood and seat removal to fit the car seat or carrycot adaptors

Release the plastic buckle **N** on the top of the seat at the back, then depress the circular white buttons on each side of the frame. Lift off the hood/bumper bar assembly. Unzip the top of the seat from the back **O**, release the velcro straps **P** around the plastic footrest and release the press studs on the sides of the seat **Q**. Lift fabric seat from the frame, recline the frame to the fully reclined position and click in the left and right adaptors, **R**. The frame is now ready for the car seat or Air-flo carrycot.

Unfolding sequence



Folding sequence

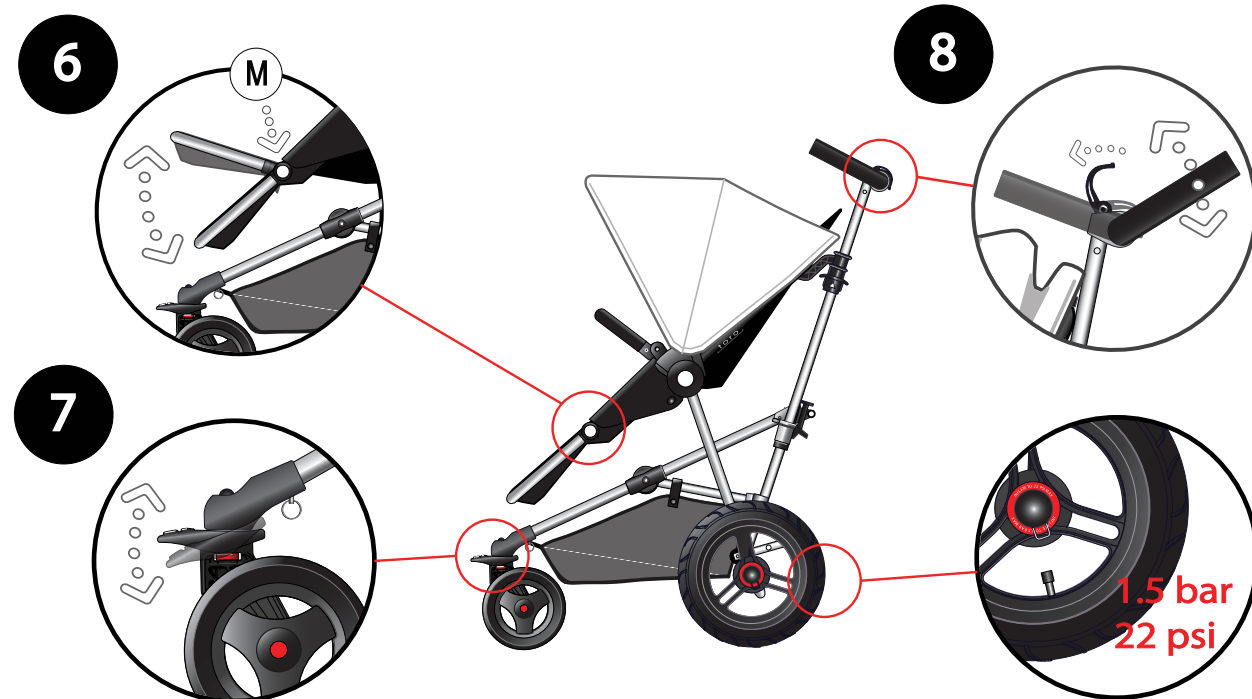
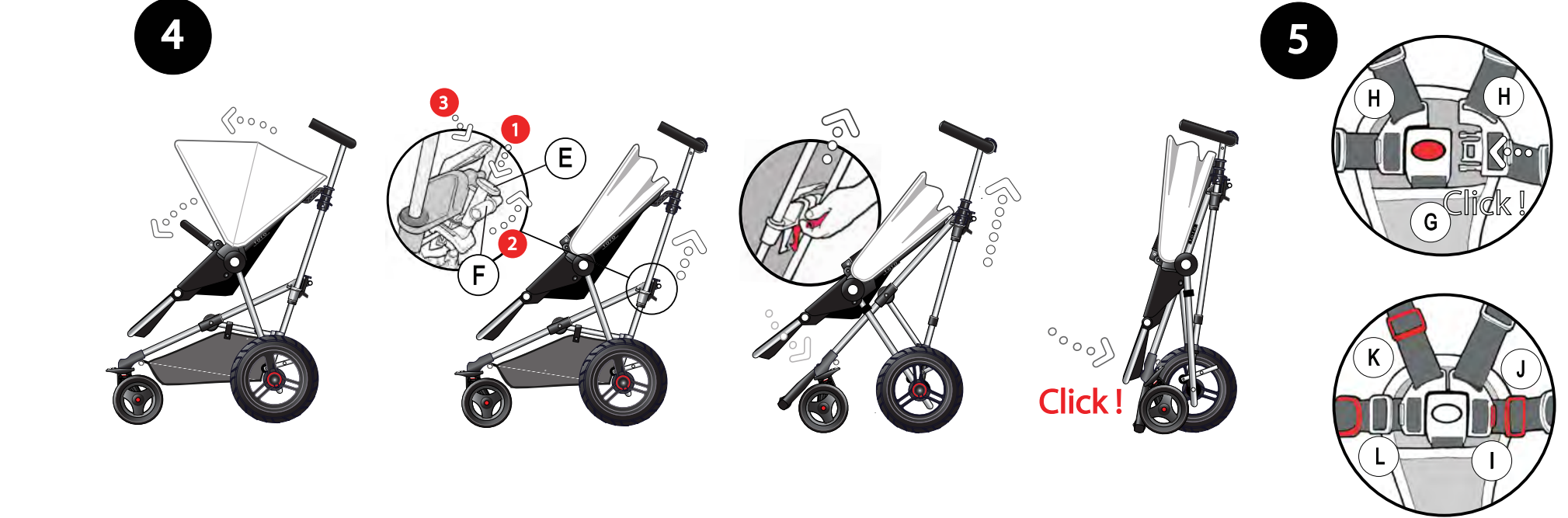

air-flo carrycot